

FRAME BRACKET 8553014

Chevrolet Silverado 1500 & GM Sierra 1500 (5-1/2', 6-1/2' & 8' Boxes)

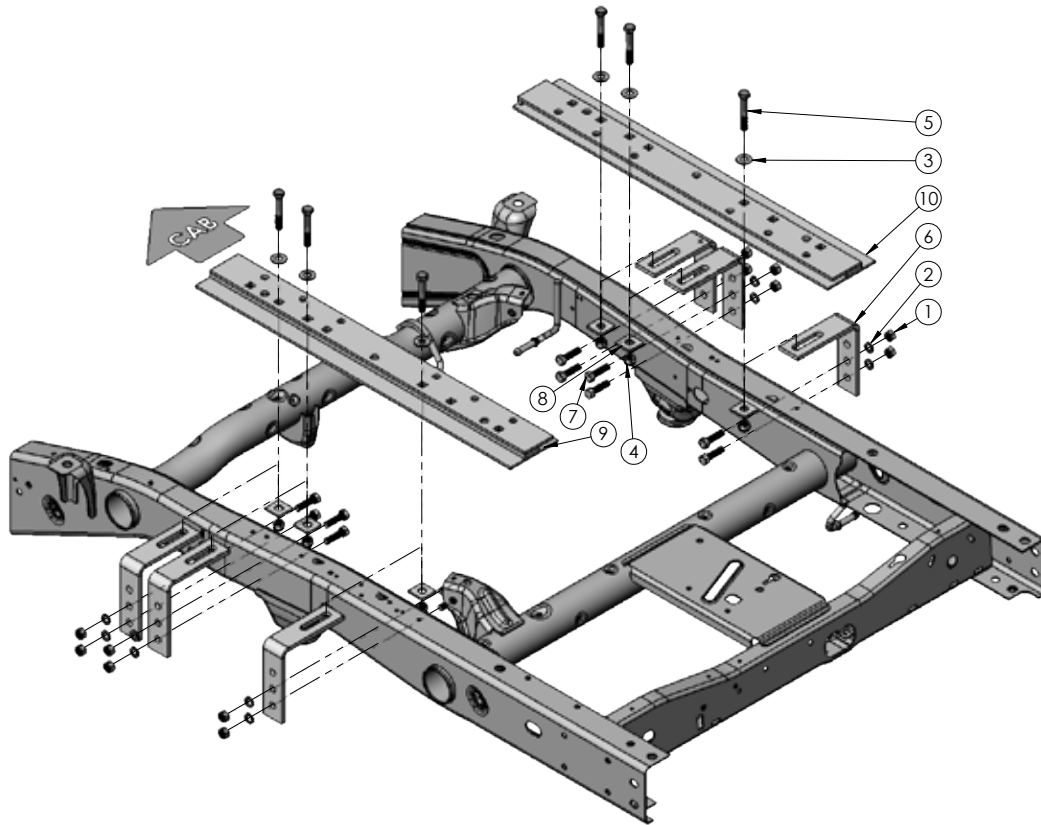

ITEM	PART #	QTY.	DESCRIPTION
1	00083	12	NUT, .50NC HEX
2	00084	12	WASHER, .50 LOCK
3	00085	6	WASHER, .50 FLAT
4	02178	6	NUT, .50NC LOCK NYLON INSERT
5	04073	6	BOLT, .50NC X 3.00 GR.5 HEX
6	14192-76	6	411D FRAME BRACKET
7	14266	12	BOLT, .50NC X 1.75 GR.5 HEX KNURLED NECK
8	14235-95	6	SPACER PLATE
9	14993-76	1	SL BASE RAIL DRIVER SIDE
10	14994-76	1	SL BASE RAIL PASSENGER SIDE
11	14238	1	FISHE WIRE .50" (NOT SHOWN)

Please order replacement parts by **PART NO.** and **DESCRIPTION.**

BOLT TORQUE SPECIFICATIONS

STANDARD BOLTS			METRIC BOLTS		
Size	Grade	Torque	Size	Grade	Torque
5/16"	5	18 ft/lbs.	8mm	8.8	23 ft/lbs.
3/8"	5	30 ft/lbs.	10mm	8.8	45 ft/lbs.
7/16"	5	50 ft/lbs.	12mm	8.8	78 ft/lbs.
1/2"	5	75 ft/lbs.	14mm	8.8	125 ft/lbs.
5/8"	5	150 ft/lbs.	16mm	8.8	160 ft/lbs.
3/4"	5	290 ft/lbs.			

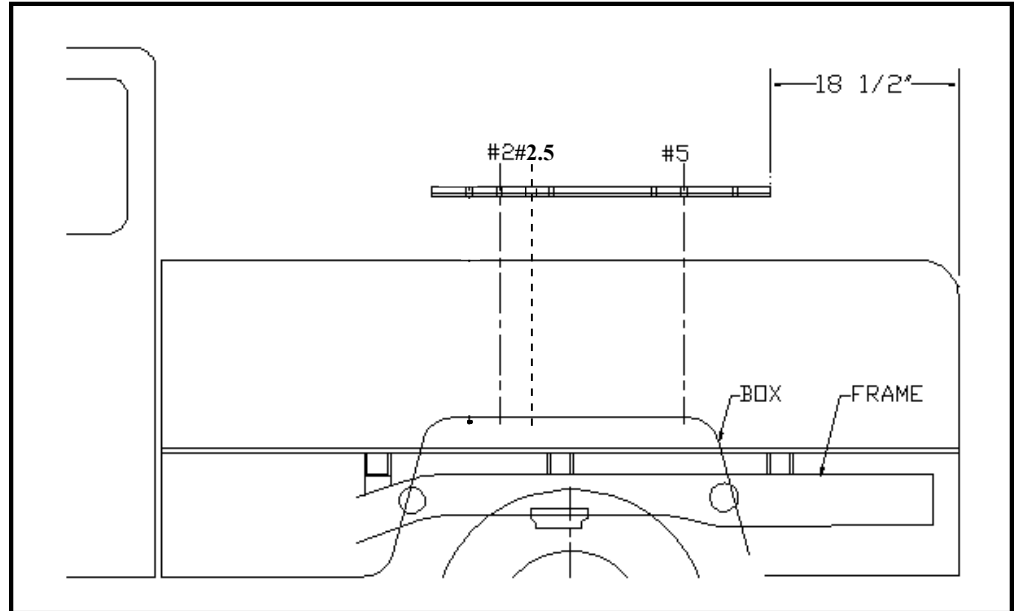

INSTALLATION

1. Completely assemble hitch. See GENERAL INSTRUCTIONS and SAFETY supplied.
2. Set hitch into back of truck, center it side to side.
3. Measure 18 1/2" from back edge of truck box to back edge of bed rail.
4. Check underneath box at bolt hole locations for any obstructions.
5. Drill two 17/32" holes thru hole #2, each bed rail.
6. Insert two 1/2" x 3" long hex bolts.
7. Slide hitch to rear position, to parallel bed rails.
8. Drill thru holes #2.5 and #5, each bed rail. Insert four 1/2" x 3" hex bolts.
9. The fish wire will be required to fish the bolts through an access hole in the frame.
10. Under box, place frame brackets onto hex bolts (six places).
11. Loosely install frame washer, 1/2" flat washer and 1/2" nylon lock nut. Press each bracket tight against frame member, tighten nuts snug against box.
12. Pilot drill* and drill 1/2" hole into truck frame at two place thru holes in each frame bracket. BE CAREFUL OF ELECTRIC OR FLUID LINES behind frame member.
13. Brackets will be bolted onto frame by drilling frame and fishing knurl bolt through frame with fish wire and attach with hex nut and lock washer on outside of bracket.
14. **TIGHTEN ALL BOLTS ACCORDING TO BOLT TORQUE SPECIFICATIONS.**
15. To pilot drill: use 1/2" drill bit or transfer punch to mark center. Drill thru with 1/4" drill.

DEMCO

4010 320th St., Boyden, IA. 51234

Phone: (712) 725-2311

Fax: (712) 725-2380

Toll Free: 1-800-54DEMCO (1-800-543-3626)

**Demco warranty policies, operator manuals, and product registration
can be found online:**

www.demco-products.com

