

FRAME BRACKET 8553018

Dodge Ram 1500 (5-1/2', 6-1/2' & 8' Boxes)

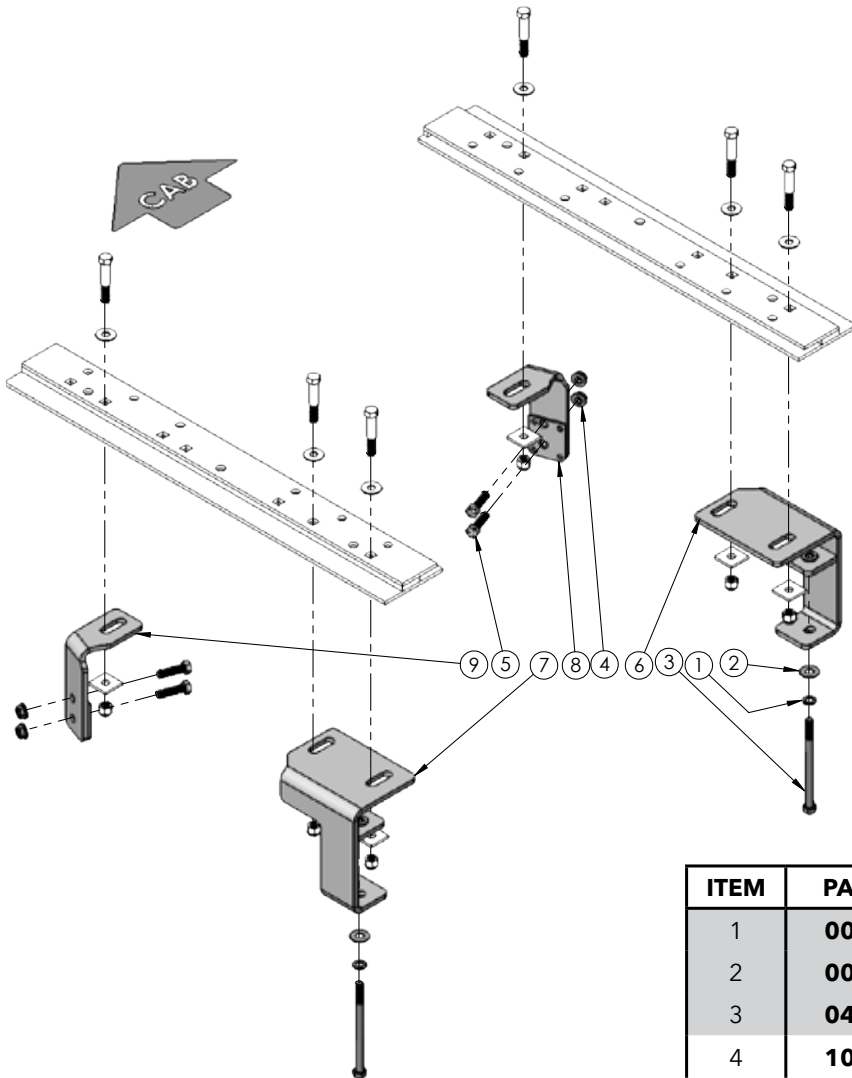

ITEM	PART #	QTY	DESCRIPTION
1	00084	2	.50 LOCKWASHER
2	00085	2	.50 FLAT WASHER
3	04916	2	BOLT .50NC X 6.50 GR5 HEX
4	10379	4	1/2" UNC FLANGED NUT
5	14266	4	.50 NC X 1.75 KNURLED NECK
6	16642-76	1	REAR BRACKET, PASSENGER
7	16643-76	1	REAR BRACKET, DRIVER
8	16644-76	1	FRONT BRACKET, PASSENGER
9	16650-76	1	FRONT BRACKET, DRIVER
-	12329	2	LOCTITE (NOT SHOWN)
-	14238	1	FISH WIRE 1/2" (NOT SHOWN)

Please order replacement parts by PART NO. and DESCRIPTION.

Introduction

8553018 General Assembly & Installation Instructions

WARRANTY POLICY, OPERATOR MANUALS & REGISTRATION

Go online to www.demco-products.com to review Demco warranty policies, operator manuals and register your Demco product.

BOLT TORQUE SPECIFICATIONS

STANDARD BOLTS			METRIC BOLTS		
Size	Grade	Torque	Size	Grade	Torque
5/16"	5	18 ft/lbs.	8mm	8.8	23 ft/lbs.
3/8"	5	30 ft/lbs.	10mm	8.8	45 ft/lbs.
7/16"	5	50 ft/lbs.	12mm	8.8	78 ft/lbs.
1/2"	5	75 ft/lbs.	14mm	8.8	125 ft/lbs.
5/8"	5	150 ft/lbs.	16mm	8.8	160 ft/lbs.
3/4"	5	290 ft/lbs.			



1. Remove the rear tires by either placing the truck on a hoist, or jacking the rear up.



2. Remove both wheel well liners by removing 12 screws from the inside of each rear wheel.

**HIGH IMPORTANCE!
BEFORE ANY DRILLING IS DONE.
MAKE SURE, THERE ARE NO
OBSTRUCTIONS UNDER THE
BOX!**

- 3a. Fully assemble the 5th wheel hitch on a flat, level surface and pin into the base rails (assembly instructions come with hitch components).

- 3b. Place assembled hitch in truck bed between the wheel wells, center it side to side and measure 20-3/4" from back edge of truck box to the back edge of bed rail for 5 1/2' & 6 1/2' (shot boxes) boxes and 23" for 8' (long box) box. See Illustration #1 on the next page.

4. Drill two 17/32" hole thru hole #2 in each bed rail. Insert two 1/2" x 3" hex bolts.

5. Lift up spring loaded locking pins and slide hitch back to rear most set of holes and lock into place. This will help to align base rails so they remain square for best operation. Drill thru hole #6 and insert 1/2" x 3" bolts. Then do the same for hole #5 of each bed rail.

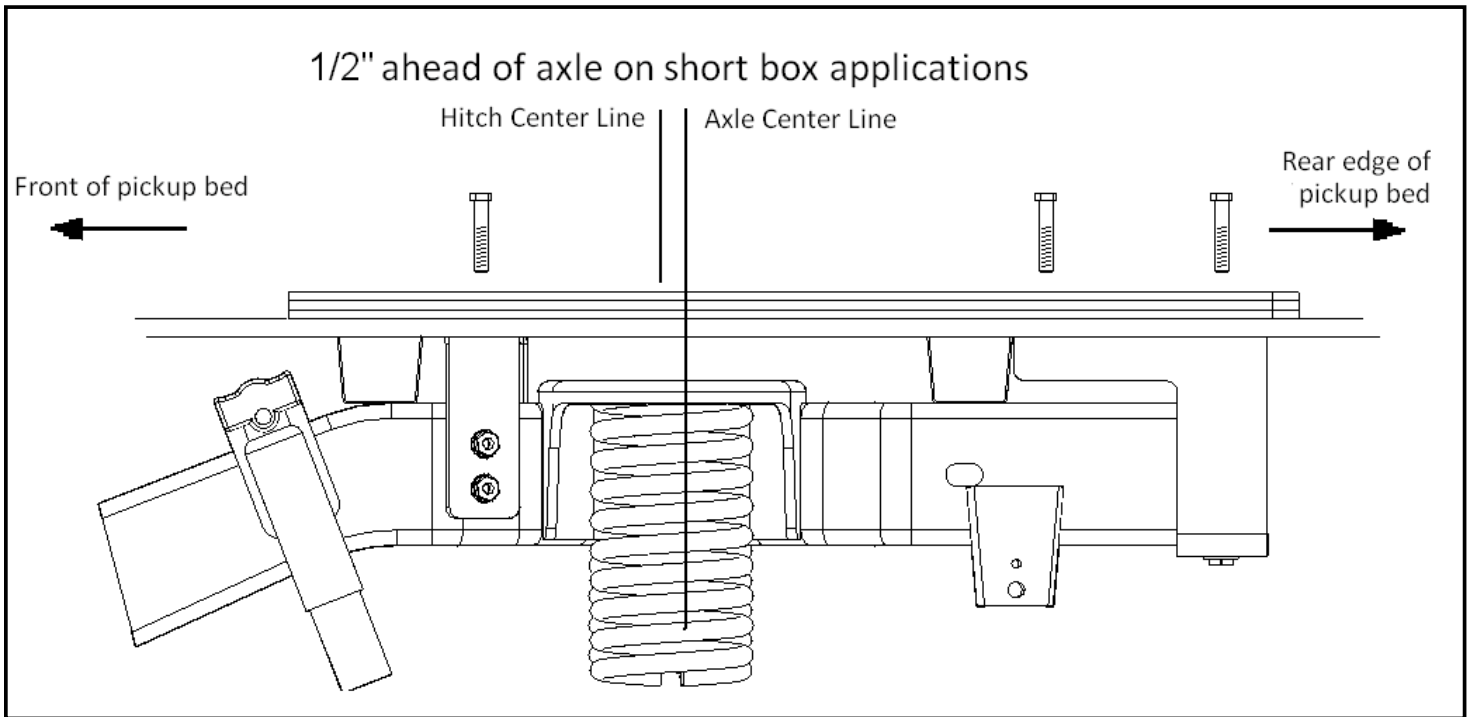
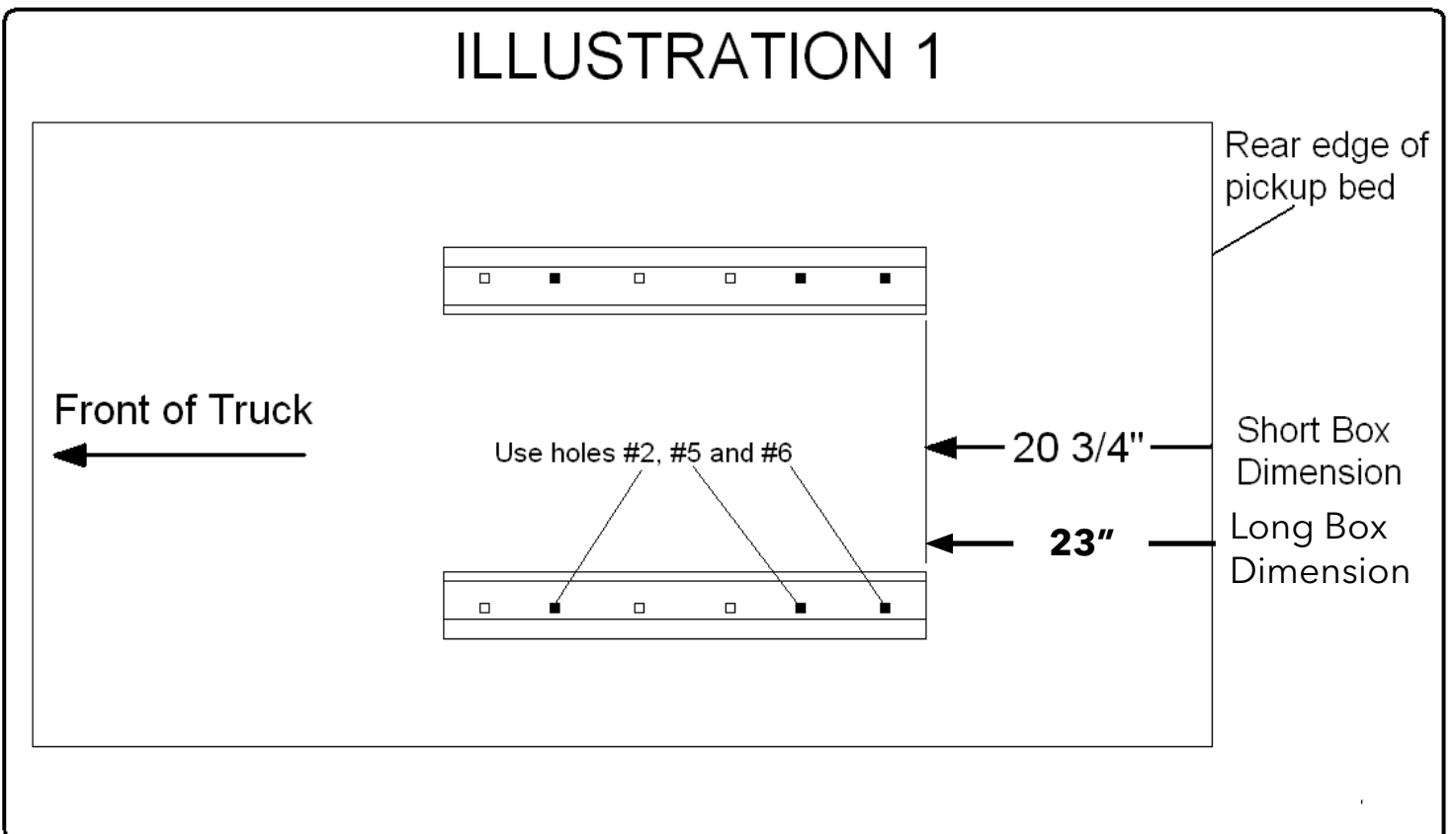

ILLUSTRATION 1



CAUTION: Do not install base rails over plastic bed liners. Plastic bed liners must be cut out of the way. Rails may be installed on spray in liners.

NOTE: Consult spray liner installer for recommended curing time.

Installation



6. Position the driver and passenger frame brackets up against the outer surface of the truck frame with the mounting tabs positioned over the frame and under the bed in line with previously drilled holes in bed where the 1/2" x 3" bolts are coming down through the bed. Picture is taken from the passengers side.

7. Make sure the front brackets (hole #2) are tight against the flat side of the truck frame and underneath the surface of the truck bed with bolts extending down through slotted holes in frame bracket tabs. Fasten and tighten bolts with square washers and 1/2" lock nuts.

8. Using the holes in the front frame brackets as drill guides, drill two 17/32" holes in the side of the frame. Each of the front frame brackets (hole #2) must be attached to the side frame of the truck with two 1/2" x 1 3/4" hex knurl bolts and 1/2" flange nuts that are fished through an access hole in the frame using the fish wire provided in the kit. There is a large oval located on outside of frame a short distance forward of the bracket.



9. On the drivers side, temporarily remove the nut from the wiring stud so that the bracket can go behind the wire harness and be placed tight to the frame. Replace wiring nut when bracket is installed



NOTE: In some cases, to aid in the install of the rear brackets, temporarily remove the screw marked by a white arrow.

10. The rear frame bracket attaches to the frame by sliding it over the outside of the frame and using the 1/2" x 6-1/2" hex bolts, 1/2" flat washers, and 1/2" lock washer to secure to frame as shown below in Illustration 3 on the page 5.

11. Tighten all bolts according to **BOLT TORQUE SPECIFICATIONS**. Failure to tighten bolts as described may result in fastener loss or failure.

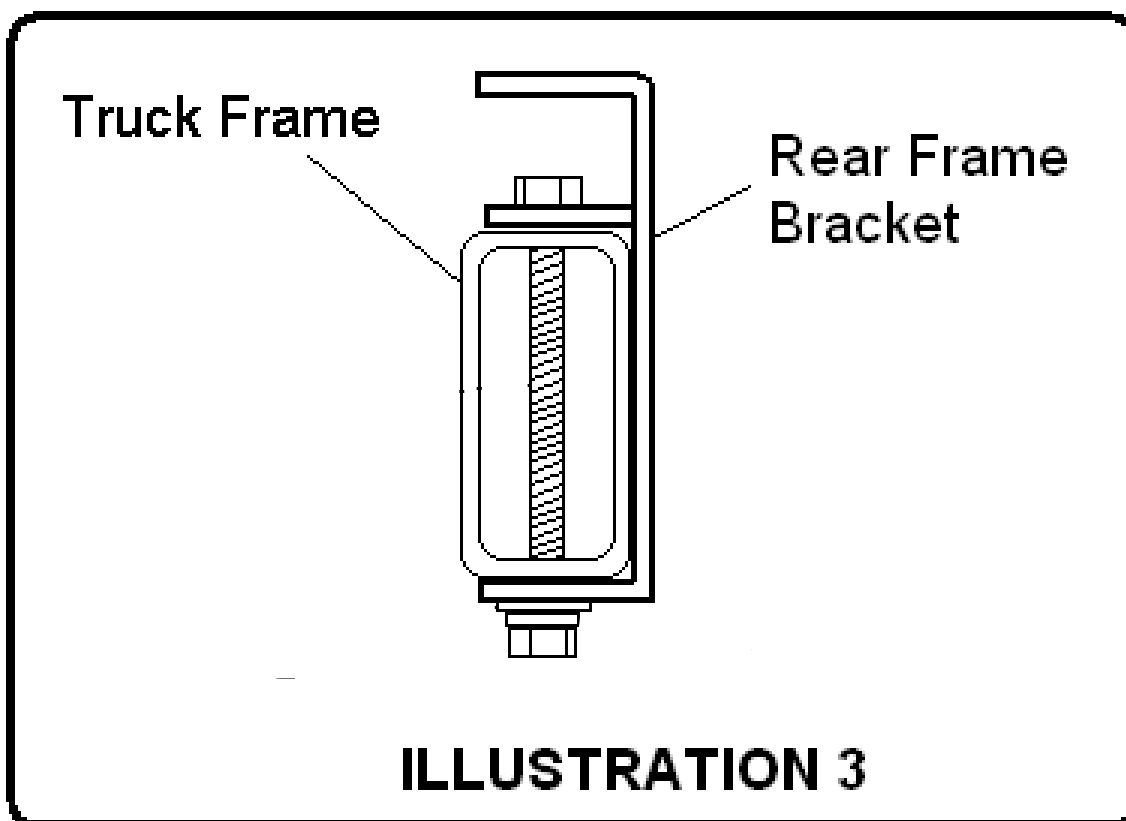

DEMCO

4010 320th St., Boyden, IA. 51234

Phone: (712) 725-2311

Fax: (712) 725-2380

Toll Free: 1-800-54DEMCO (1-800-543-3626)

**Demco warranty policies, operator manuals, and product registration
can be found online:**

www.demco-products.com

